

1216 INSTRUCTOR'S DESK ASSEMBLY INSTRUCTIONS

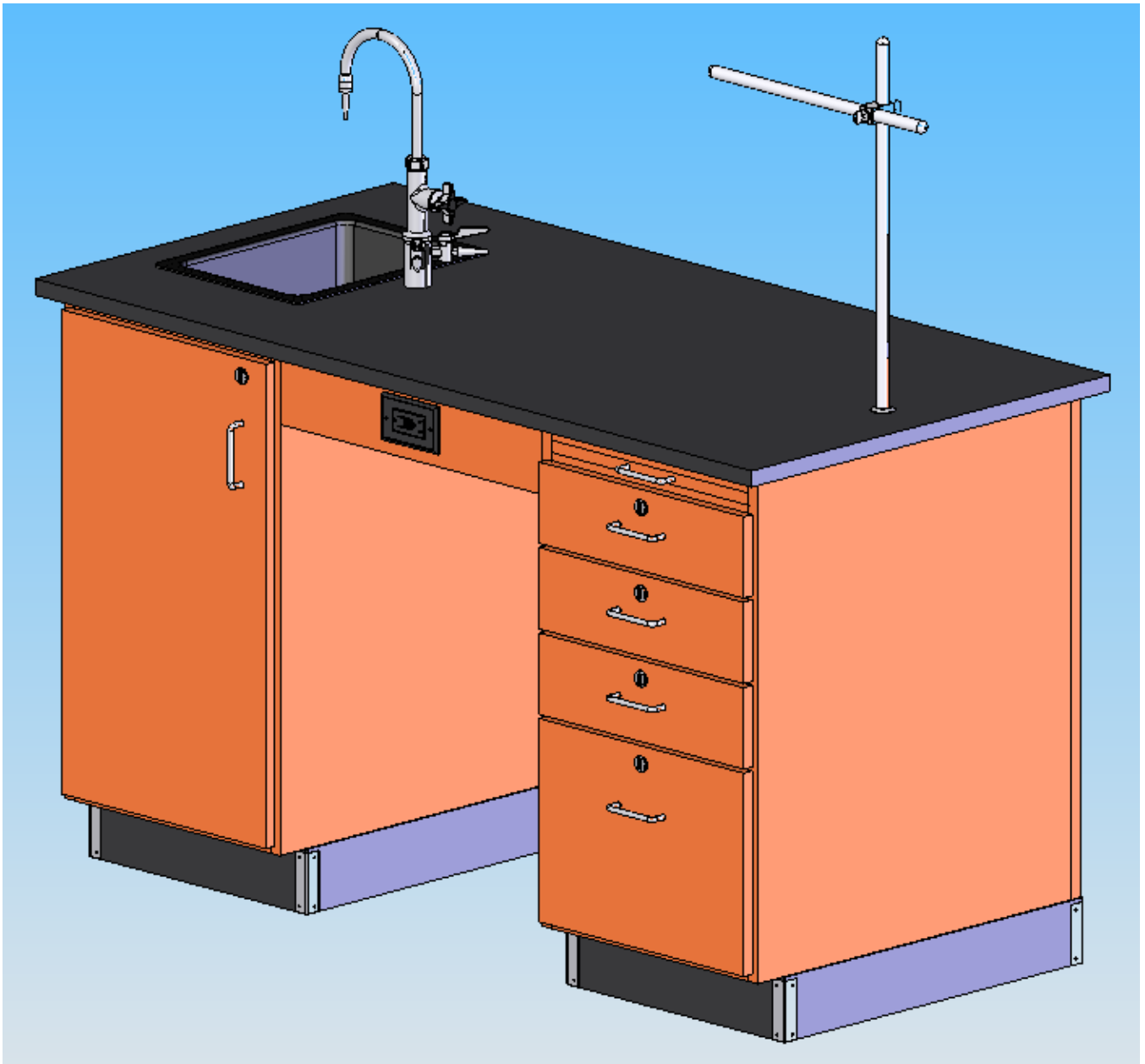

TABLE OF CONTENTS

	PAGE
ASSEMBLY COMPONENTS	3
REVISIONS TABLE	3
BASE ASSEMBLY	4
BACK PANEL ASSEMBLY	4
APRON RAIL ASSEMBLY	5
TOP ASSEMBLY	5
SINK ASSEMBLY	6
FIXTURE ASSEMBLY	6
ROD SOCKET ASSEMBLY	7
BASE MOULDING ASSEMBLY	7
PULL ASSEMBLY	8

ASSEMBLY COMPONENTS

Items Included In Hardware Box	Part #		Part #
ASSEMBLY INSTRUCTIONS		1-HARDWARE BOX	
18FT-RUBBER BASE	100283	1-TOP, EPOXY 30X60 BLK FIXT	100499
1-ELECTRICAL BOX, 3X2X2.5	100033	1-METAL FILE HANGER	100178
1-GFI ELECTRICAL OUTLET	100034	1-APRON 4.5X22, W/ELEC	211289
4-SCREW, 6X1/2 PPH	100475	1-BACK PANEL, 35X58	213961
2-CLEAT, RAIL	100355	1-FIXTURE, L65-WSA-DIV	100074
8-SCREWS, 8X3/4 TRUSS HEAD	100649	1-SINK, EPOXY L5C BLK	100692
16-SCREW, 8X1 1/4 SQ WASH-HEAD	100478	1-ROD UPRIGHT 3/4 DIA X36 L	100004
6-STAINLESS STEEL CORNERS	100057	1-ROD, CROSSBAR 3/4 DIA X 18 L	100005
24-SCREWS, 6X1/2 SS PTH	100064	1-SINK STRAINER/OUTLET	100055
1-ROD SOCKET ASSY	206505	1-SINK TRAP, PLASTIC ADJ.	100056
1-ROD CLAMP, 3/4X3/4	100002	1-SINK STOPPER	100112
2-THUMB SCREW	100490	1-SILICONE SEALANT	100711

REV	DESCRIPTION	DATE	INITIAL
---	Original Created	3-8-07	JWD

Assembly Instructions for 1216K Instructor's Desk

Items not included but needed for assembly:

1. Screwdrivers and Wrenches
2. Liquid Nail or silicone adhesive (can be found in hardware stores)
3. Contact Cement
4. Tape measure

Instructions:

1. Place the cupboard cabinet centered over the plumbing and gas.

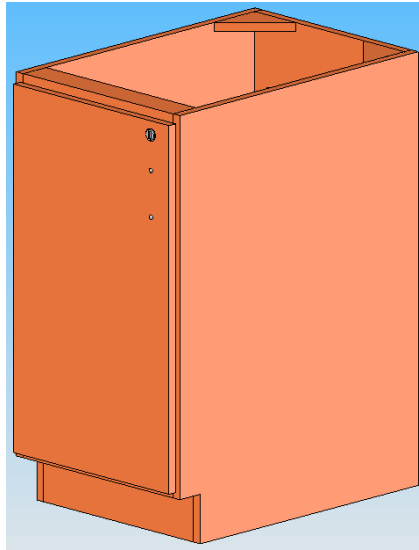

2. Place the second cabinet in line with the cupboard cabinet leaving a 22" space between the cabinets for the back panel.

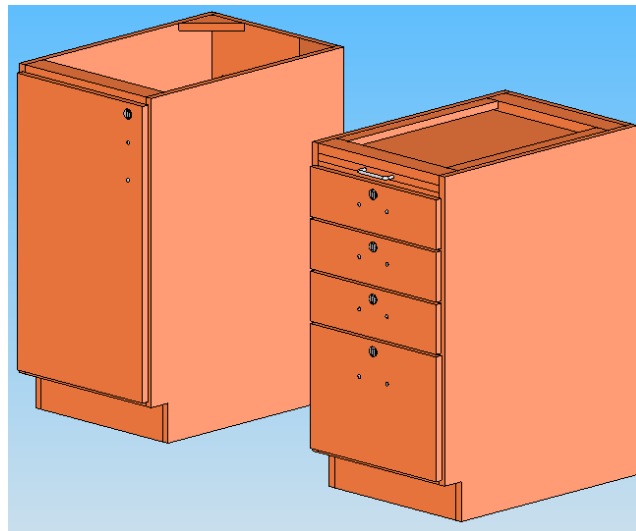

3. Attach back panel to the back of the cabinets using the cleats and #8 x 1-1/4" phil pan head screws provided. It is recommended that one person hold the back panel in place while a second person actually attaches the panel. Make sure back panel is flush with the outside edges of the cabinets.

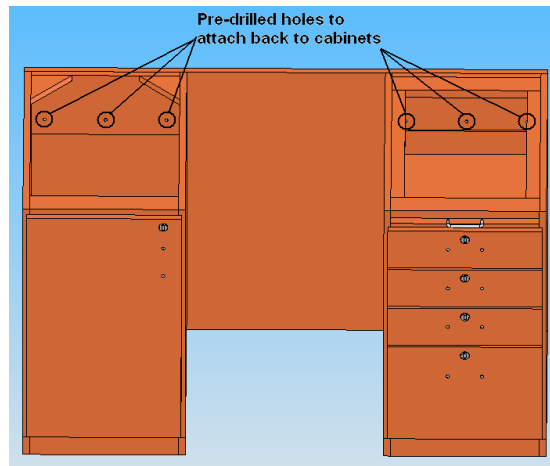

4. Attach front apron between cabinets using the cleats and the 100649 #8 x $\frac{3}{4}$ " screws provided. For aesthetic purposes you may want to set the apron in 1".

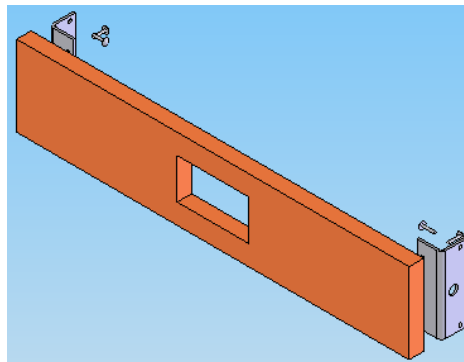
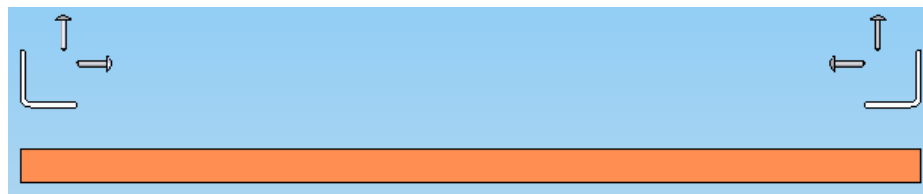

5. Outline the top of the base unit with the Liquid Nail or silicone adhesive and place top on the unit. Let cure. Be sure to center the top on the base unit before the glue dries.

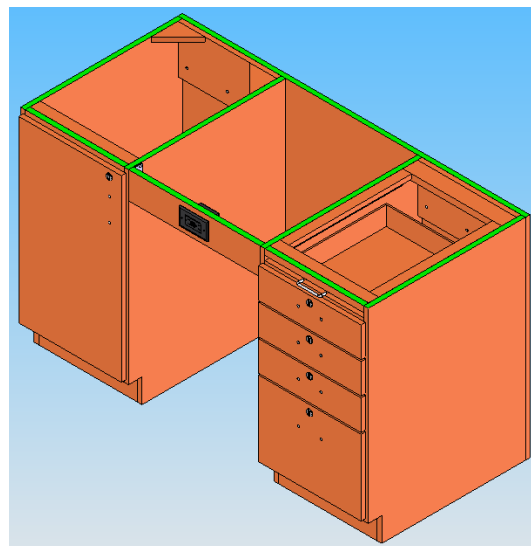

6. Clean the top with water only. Be sure the area the sink is dropped in is clean and dry.
7. Put a bead of silicone seal along the cutout for the sink on the top. Lower sink in place.

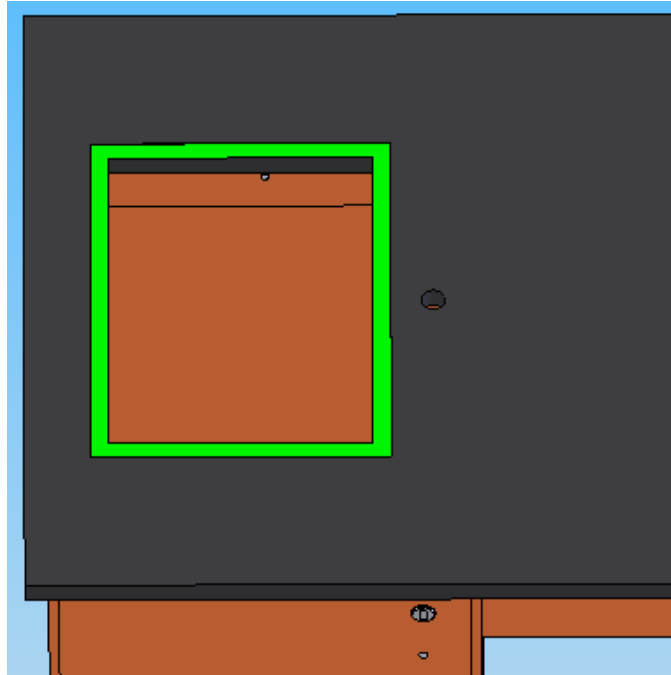

8. Mount fixtures into place.

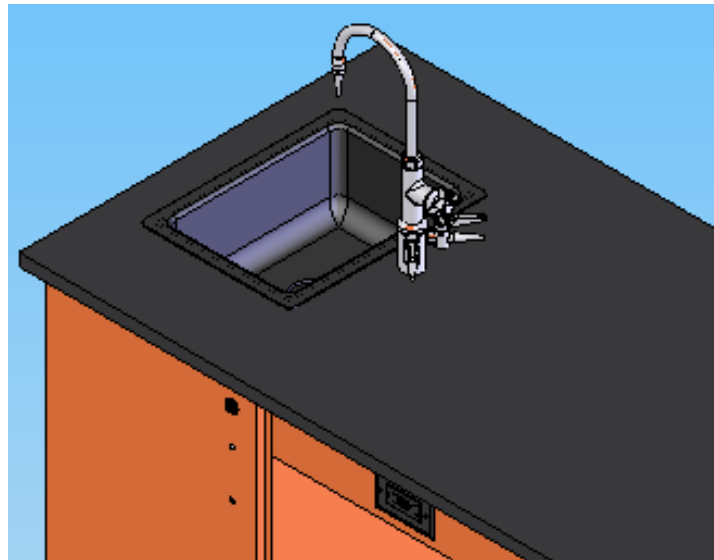

9. Assemble the Rod Socket Assembly as shown in Figure 9A.
Attach Rod Sockets to Top as shown in Figure 9B.

Figure 9A

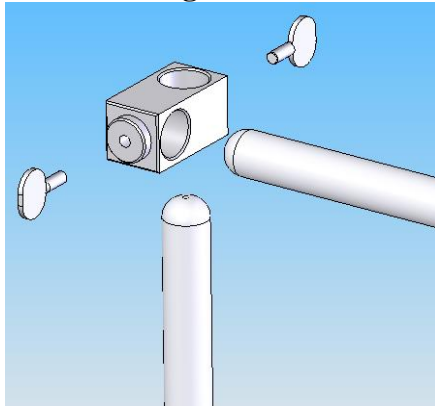
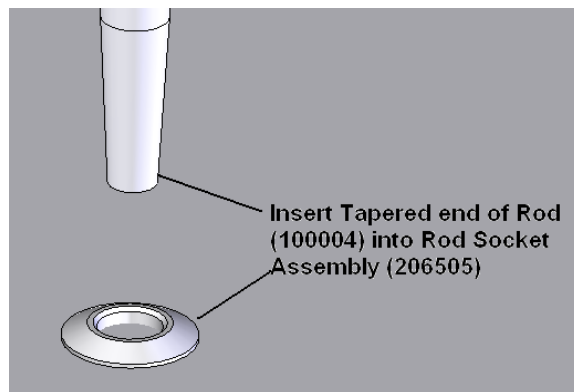
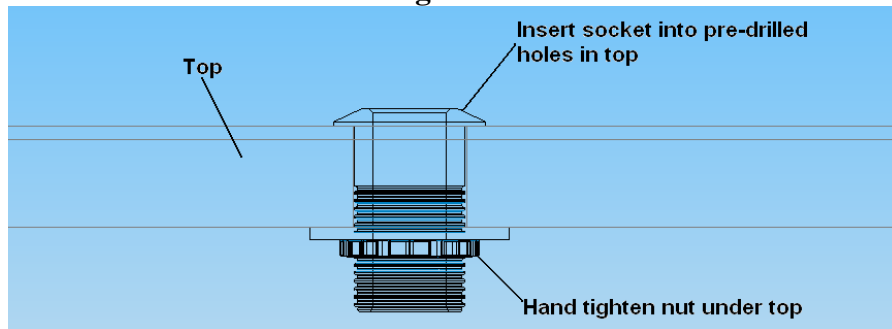
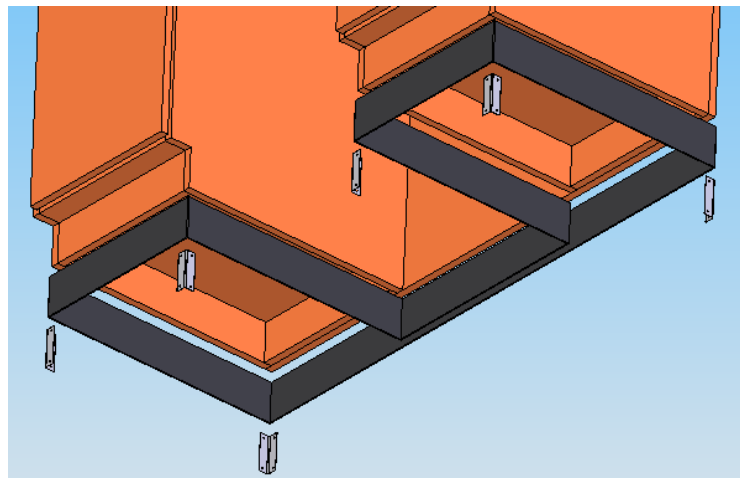

Figure 9B



10. Attach the rubber base molding using contact cement. After the molding is in place; screw stainless steel corner brackets on each corner using the (100064) #6 x 1/2" screws provided, over the base molding.



11. Reverse pulls to the exterior of unit as shown.

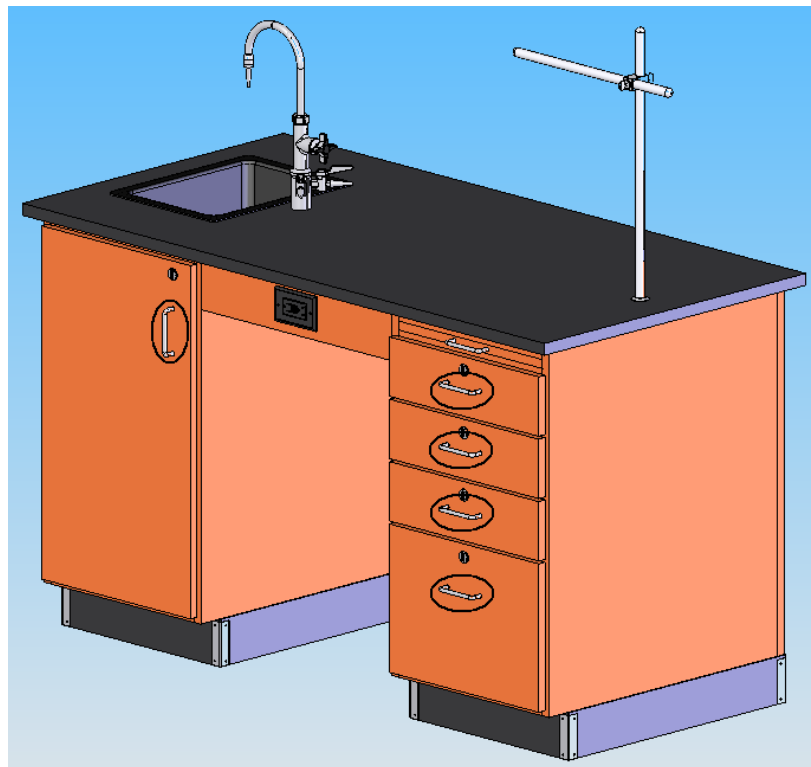

12. All water, electrical and gas connections should be performed by a trained professional.