

1116 INSTRUCTOR'S DESK ASSEMBLY INSTRUCTIONS

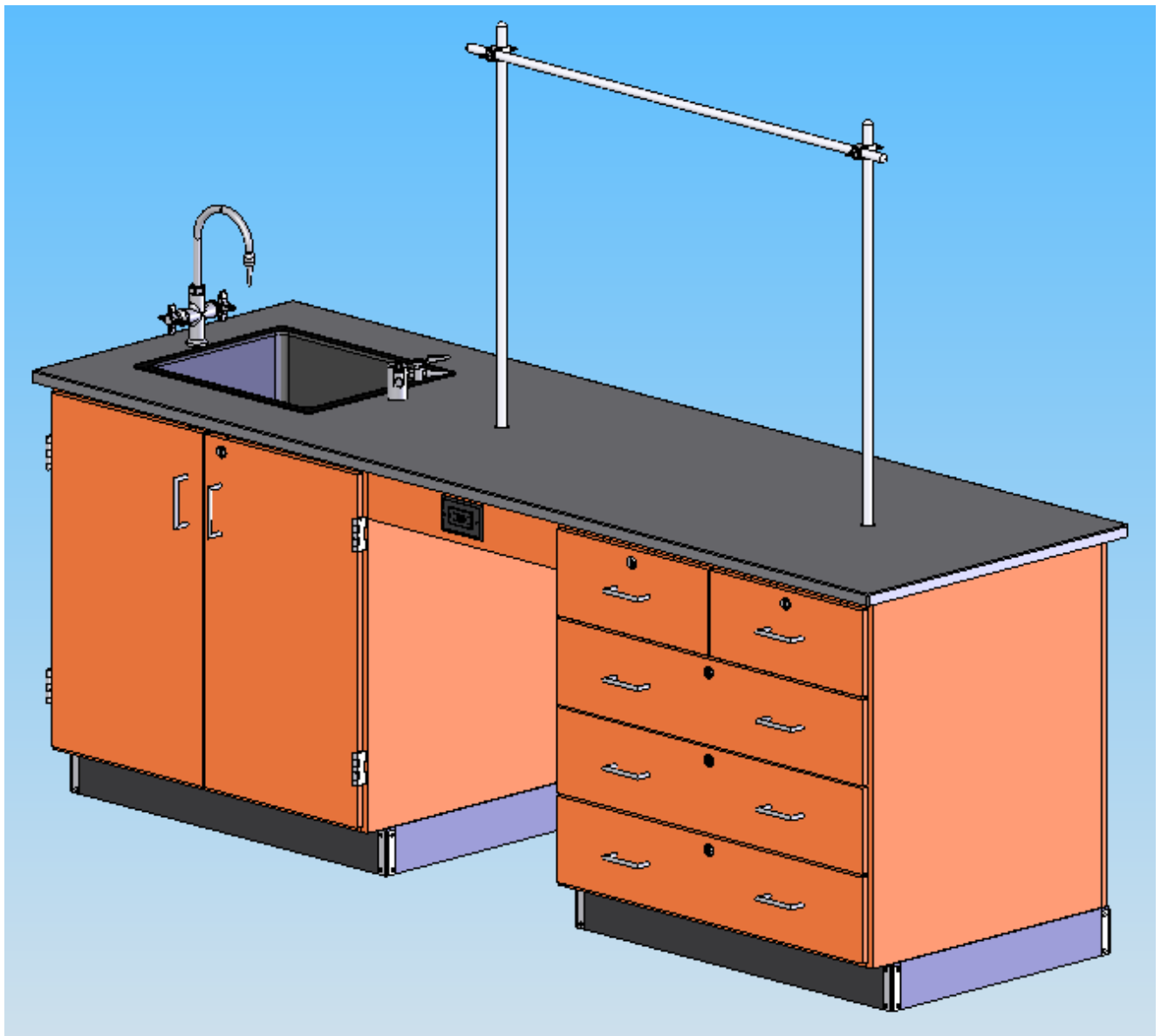

TABLE OF CONTENTS

	PAGE
REVISIONS TABLE	1
ASSEMBLY COMPONENTS	2
BASE ASSEMBLY	4
BACK PANEL ASSEMBLY	4
APRON RAIL ASSEMBLY	5
TOP ASSEMBLY	5
SINK ASSEMBLY	6
FIXTURE ASSEMBLY	6
ROD SOCKET ASSEMBLY	6
BASE MOULDING ASSEMBLY	7
PULL ASSEMBLY	8

ASSEMBLY COMPONENTS

Items Included In Hardware Box	Part #		Part #
1-ASSEMBLY INSTRUCTIONS		1-HARDWARE BOX	
24 FT RUBBER BASE	100283	2-UPRIGHT RODS 3/4 DIA. X 36 L.	100004
1-ELECTRICAL BOX, 2X2.5	100033	1-CROSSBAR ROD, 3/4 DIA. X 48 L.	100006
1-GFI ELECTRIC OUTLET	100034	1-FIXTURE, L2900-132AWSA 90 DEG.-GAS	100048
4-SCREWS, 6X1/2 PPH	100475	1-FIXTURE,L414 HOT & COLD MIXING	100467
2-ROD SOCKET ASSEMBLY	206505	1-EPOXY SINK, L30 BLK	100699
2-ROD CLAMP ASSEMBLY	206506	1-EPOXY TOP, 30 X 96, BLK, FIXT	100497
6-STAINLESS STEEL CORNERS	100057	1-APRON WITH ELECT. 4.5X22	211289
24-STAINLESS STEEL SCREW, 6X1/2	100064	1-BACK PANEL, 94X35	212671
1-OUTLET/STRAINER EPOXY,BLK	100055	8-TRUSS HEAD SCREWS, 8 X 3/4	100649
1-PLASTIC ADJ SINK TRAP	100056	16-SCREW, WASHER FLAT HEAD #8X1 1/4	100478
1-SINK STOPPER 1 1/2, BLK	100112	2-CLEAT RAILS	100355
1-CLEAR SILICONE SEALANT	100711		

REV	DESCRIPTION	DATE	INITIAL
---	Original Created	2-28-07	JWD



Assembly Instructions for 1116K and 1216K Instructor's Desk

Items not included but needed for assembly:

1. Screwdrivers and Wrenches
2. Liquid Nail or silicone adhesive (can be found in hardware stores)
3. Contact Cement
4. Tape measure

Instructions:

1. Place the cupboard cabinet centered over the plumbing and gas.

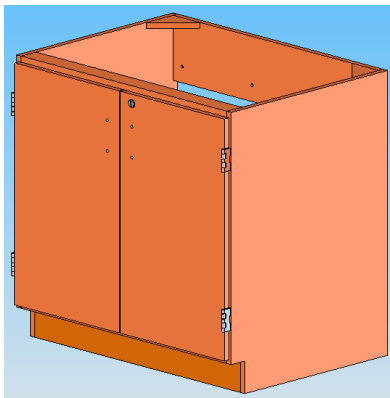

2. Place the second cabinet in line with the cupboard cabinet leaving a 22" space between the cabinets for the back panel.

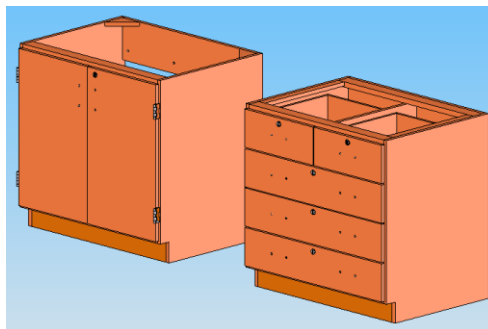

3. Attach back panel to the back of the cabinets using the cleats and #8 x 1-1/4" phil pan head screws provided. It is recommended that one person hold the back panel in place while a second person actually attaches the panel. Make sure back panel is flush with the outside edges of the cabinets.

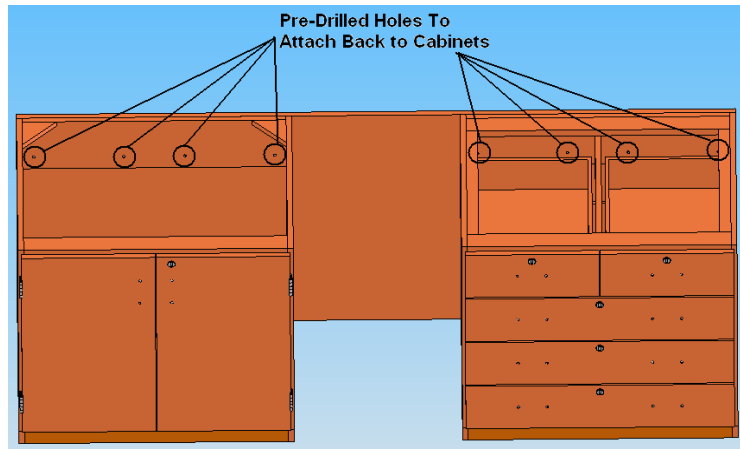

4. Attach front apron between cabinets using the cleats and the 100649 #8 x $\frac{3}{4}$ " screws provided. For aesthetic purposes you may want to set the apron in 1".

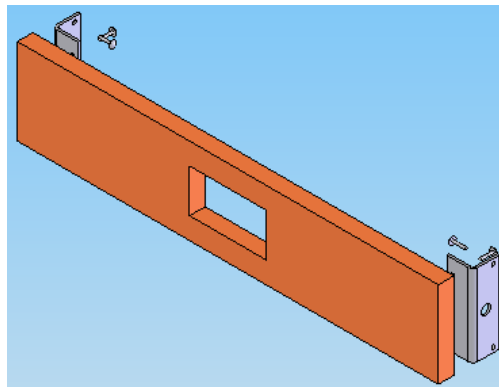
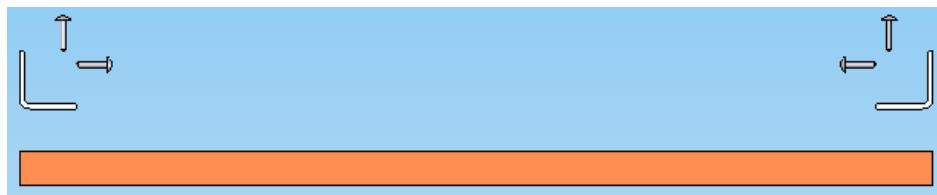

5. Outline the top of the base unit with the Liquid Nail or silicone adhesive and place top on the unit. Let cure. Be sure to center the top on the base unit before the glue dries.

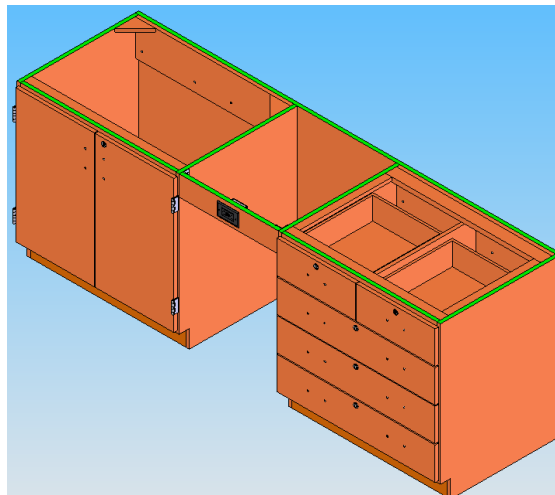

6. Clean the top with water only. Be sure the area the sink is dropped in is clean and dry.
7. Put a bead of silicone seal along the cutout for the sink on the top. Lower sink in place.

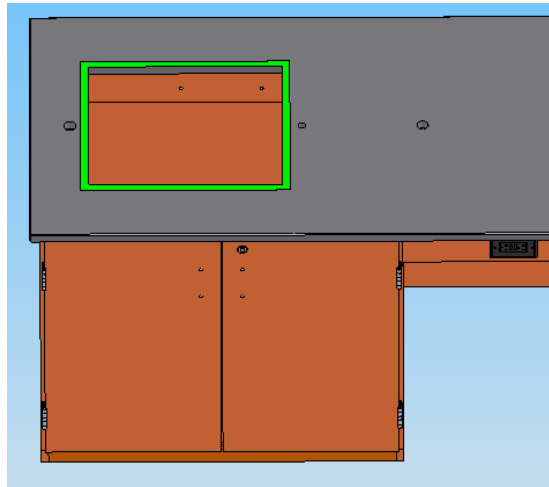

8. Mount fixtures into place.

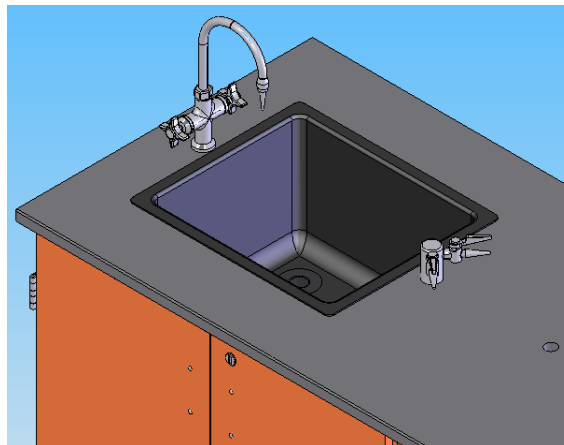

9. **(If Applicable)** Assemble the Rod Socket Assembly as shown in Figure 9A.
(If Applicable) Attach Rod Sockets to Top as shown in Figure 9B.

Figure 9A

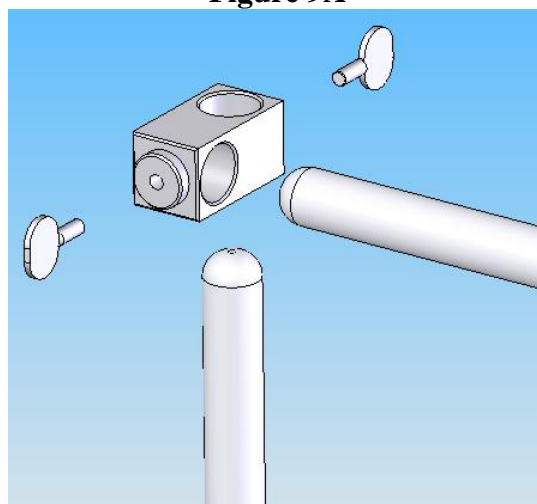
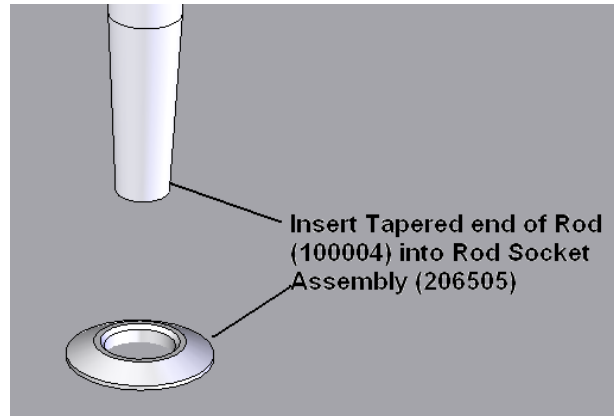
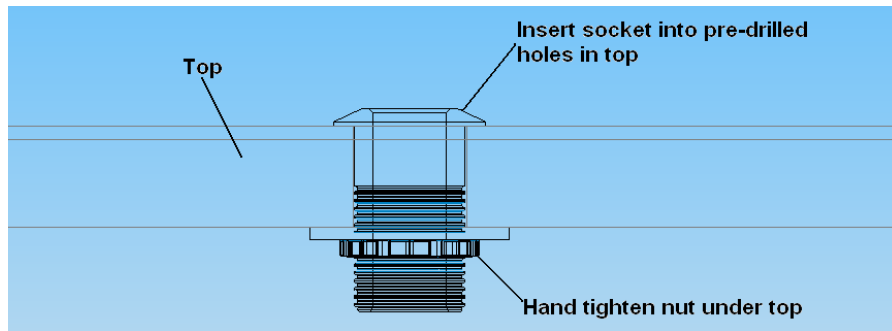
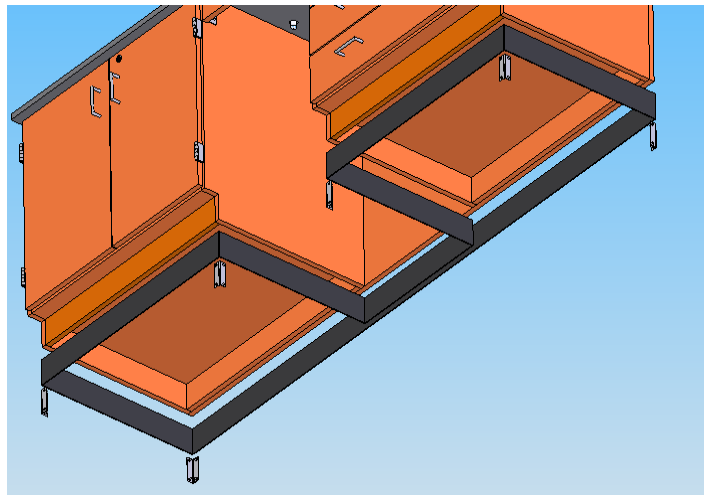

Figure 9B



10. Attach the rubber base molding using contact cement. After the molding is in place; screw stainless steel corner brackets on each corner using the (100064) #6 x 1/2" screws provided, over the base molding.



11. Reverse pulls to the exterior of unit as shown.

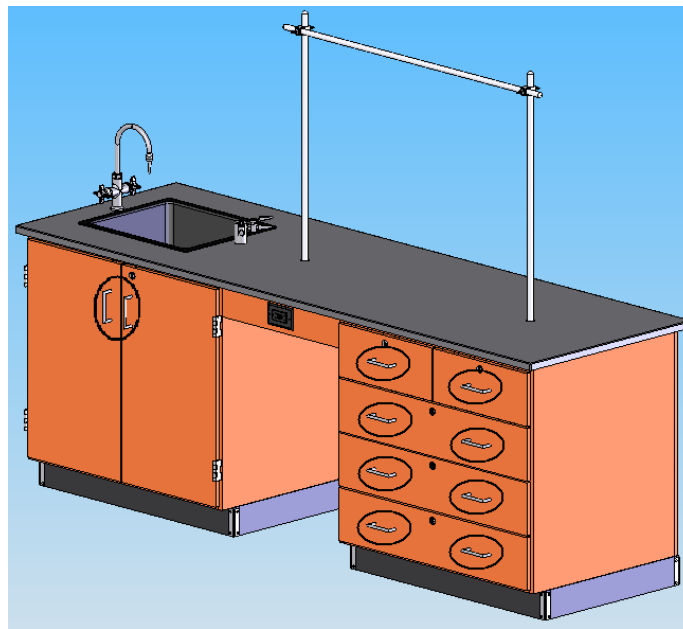

12. All water, electrical and gas connections should be performed by a trained professional.