

TOP VIEW

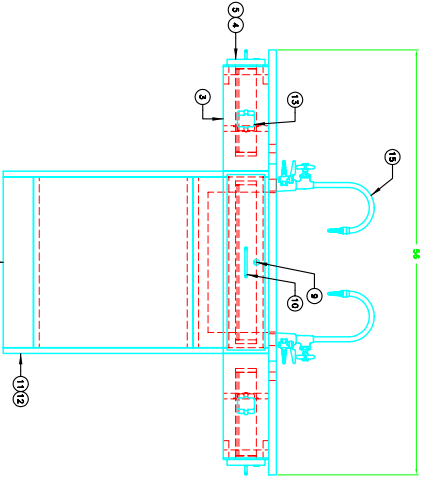

FRONT VIEW

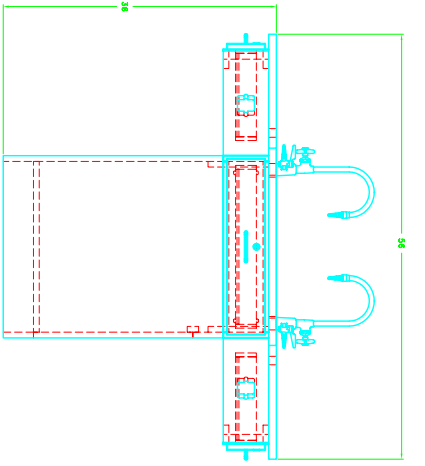

SIDE VIEW

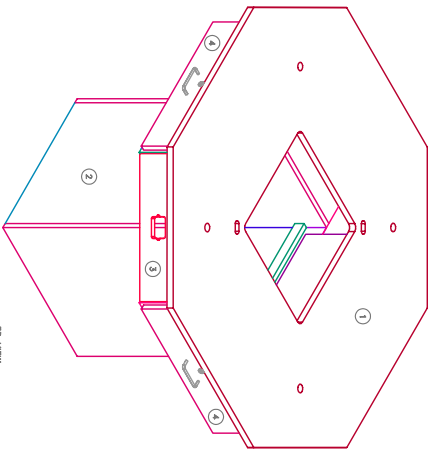

3D VIEW
= B
(SHOWN FOR CLARITY)

NOTE:
 ITEM 17: BRAIN KIT/EPXY SINKS W/TRAP (209510) INCLUDES:
 (1) SINK TRAY/PLASTIC ADJUSTABLE (209505)
 (1) SINK STOPPER 1/2 BLACK (209112)
 (1) SINK STOPPER 1/2 BLACK (209113)
 (1) BEST-SUCKING SEAL (100711)

BAL	QTY	UM	P/N	DESCRIPTION
1	1	EA	100990	TOP-EPXY KIT, 1.007869X58, BLK, FXT, LOC
2	1	EA	209790	CABINET, 1.51 BK, 1.91 BK
3	1	EA	209790	CABINET, 1.51 BK, 1.91 BK
4	4	EA	209792	TRC
5	4	EA	209792	SLIDE, DRW, ASSY, 1/2 5/8 EXT, 100# WH
6	4	EA	211197	LOCK, ASSY, DISC, MAL
7	4	EA	209523	PULL, ASSY, 10MM WTR, BRGM, WTR, CHROME
8	1	EA	209514	CORNER BASE, ASSY, SET, 40MM/ENSW/SCRM
9	1	EA	209514	CONNER BASE, ASSY, SET, 40MM/ENSW/SCRM
10	4	SET	209505	RND, SOCKET, ASSY, SOCKET, W/SHER, NUT
11	4	SET	209505	RND, SOCKET, ASSY, SOCKET, W/SHER, NUT
12	4	EA	100997	SINK, EPXY, LOC, BLK
13	1	EA	100997	SINK, EPXY, LOC, BLK
14	1	EA	209510	BRAIN KIT/EPXY SINKS W/TRAP

-ITEM 8 IS USED TO ATTACH DRAWER GUIDES TO CABINET
 -ITEM 7 IS USED TO ATTACH DRAWER GUIDES TO DRAWER BOX
 -ITEM 9 WAS 207012

REV	DESCRIPTION	DATE	BY	CHKD	APPV	DATE	BY	CHKD	APPV
1	ITEM 18 WAS CHANGED TO 100997	7/19/2014	JAB/KA						
2	QTY ON ITEM 4 WAS CHANGED FROM 3 TO 4.	6-18-09	JCR/SS						
3	ITEM 9 WAS 207012	5/07/09	JUT						

DATE: 7/19/2014
 TIME: OCTAGON WORKSTATION W/FED BASE
 PART NUMBER: 1516K
 REV: 3