

## 3216 WALL SERVICE BENCH

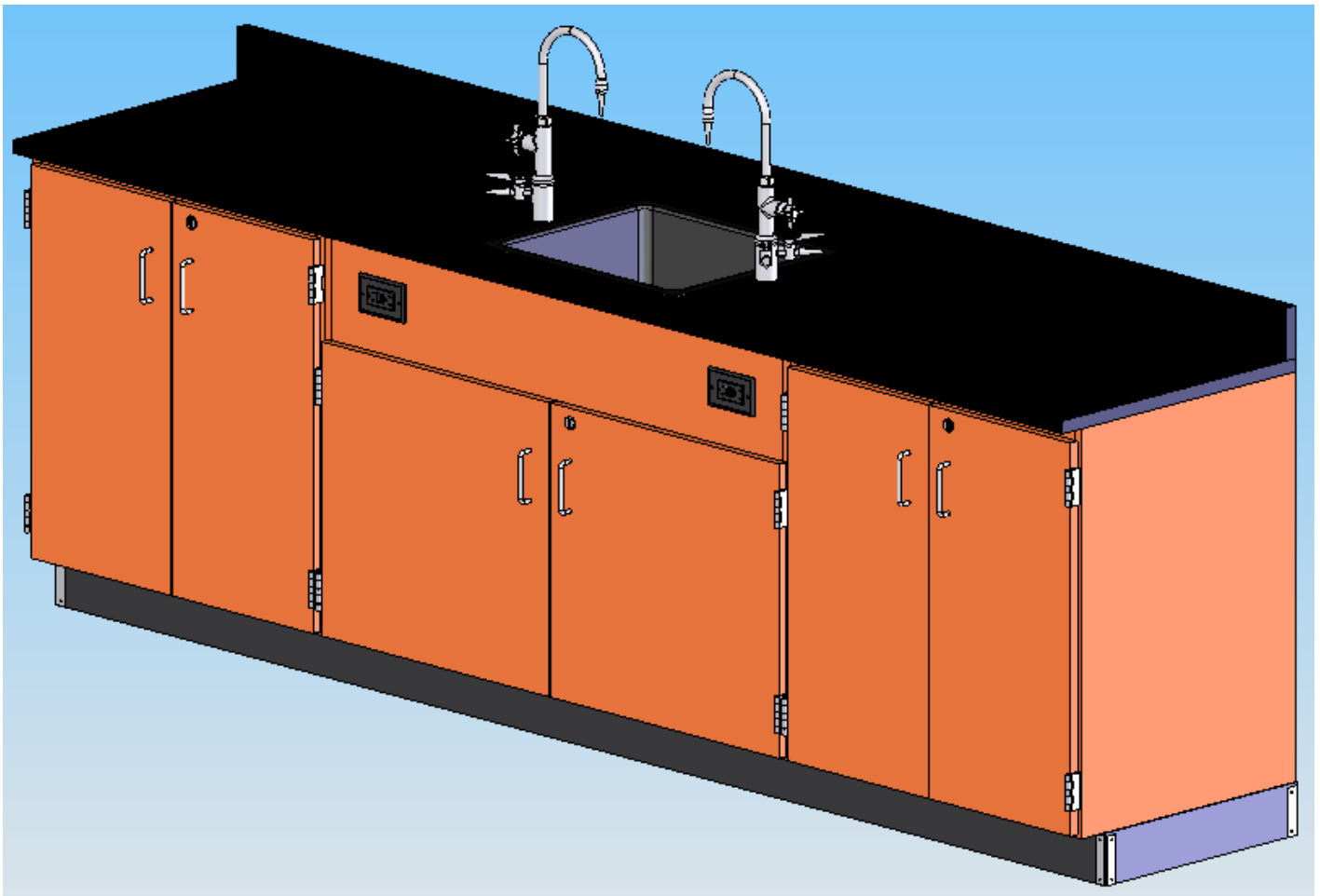

# TABLE OF CONTENTS

	PAGE
REVISIONS TABLE.....	3
ASSEMBLY COMPONENTS.....	3
BASE BRACKET.....	4
TOP ASSEMBLY.....	5
BACKSPLASH ASSEMBLY.....	5
SINK ASSEMBLY.....	5
FIXTURE ASSEMBLY.....	5
BASE MOULDING ASSEMBLY.....	6
PULL ASSEMBLY.....	6

# ASSEMBLY COMPONENTS

Items Included In Hardware Box	Part #		Part #
1-INSTRUCTION SHEET		1-HARDWARE BOX	
12.30-RUBBER BASE	100283	2-FIXTURE,L65-WSA-DIV	100074
8-SHELF CLIPS	100027	1-SINK, EPOXY L30, BLK	100699
2-ELECTRICAL BOXES, 2X3X2.5	100033	2-ADJ SHELVES, 18X28.18	200405-1356
2-ELECTRICAL GFI OUTLET	100034	1-EPOXY TOP, 78X24, BLK, FIXT	207824-A
8-SCREWS, 6X1/2 PPH	100475	1-EPOXY TOP, 78X4, BLK, BKSPLSH	207824-B
2-STAINLESS STEEL CORNERS	100057	1-EPOXY TOP, 30X24, BLK, FIXT	207824-C
8-SS SCREWS, 6X1/2 PTH	100064	1-EPOXY TOP, 30X4, BLK, BKSPLSH	207824-D
1-SINK, OUTLET/STAINER EPOXY	100055	1-SINK STOPPER, 1 1/2 BLK	100112
1-SINK TRAP, PLASTIC ADJ	100056	1-SILICONE SEALANT, CLEAR	100711

REV	DESCRIPTION	DATE	INITIAL
---	Original Created	3-267	JWD

## Assembly Instructions for 3216K WALL SERVICE BENCH

Items not included but needed for assembly:

1. Screwdriver with Phillips bit
2. 1/8" drill bit
3. 1/2" and 9/16" wrenches
4. Tape measure
5. Level
6. Contact Cement
7. Liquid Nails or Silicone adhesive

**Inspect all components for shipping damage.**

Instructions:

1. Position the sink unit cabinet centered over your utility hook-ups.

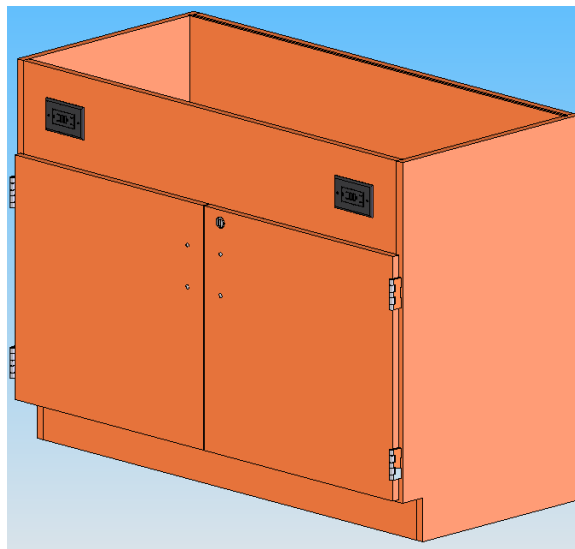

2. Position the other two cabinets on either side of the sink unit. Make sure all the cabinets are tight together. Fasten them to the wall.

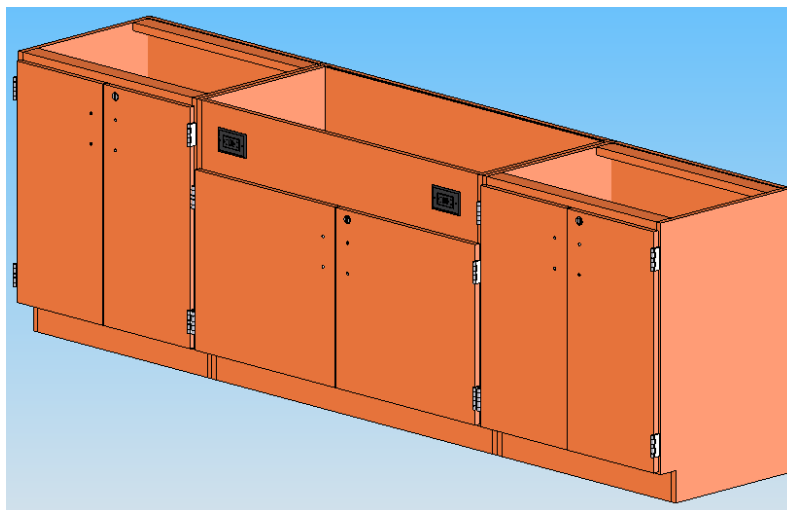

3. Apply a bead of silicone adhesive to the top edges of the cabinets. Position the top on top of the cabinets. Make sure one cut edge of the top is flush with the edge of the sink cabinet. Be sure the cut end of the tops will fit together. Apply a bead of silicone adhesive to the two cut edges of the tops. Press firmly to connect the two sections of tops together. Also, be sure the top is tight against the wall. (Do this before the silicone adhesive on the cabinet edges sets up.) Let cure for 6 – 12 hours.

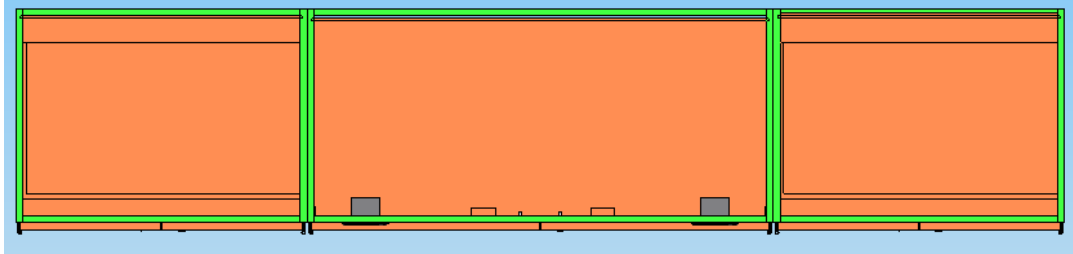

4. Apply a bead of silicone caulk to the cut edge of the back splash. Position it on the back edge of the top along the wall. Also apply a bead on the edges of the back splash where two sections meet. Make sure it is tight against the wall and the cabinet top.

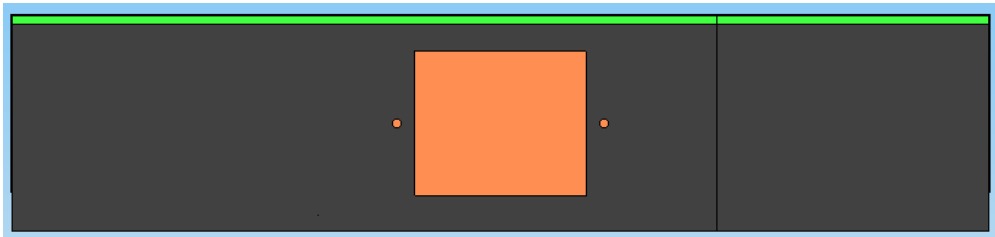

5. Apply a generous bead of silicone adhesive caulk to the sink opening in the top. Lower the sink into the opening. Wipe off any excess caulk and allow to set. Clean top with water only, making sure sink area is clean and dry.

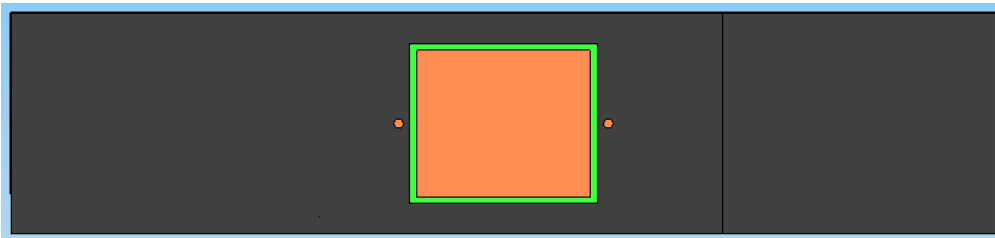

6. Install the multi service fixtures in the holes provided in the cabinet top.

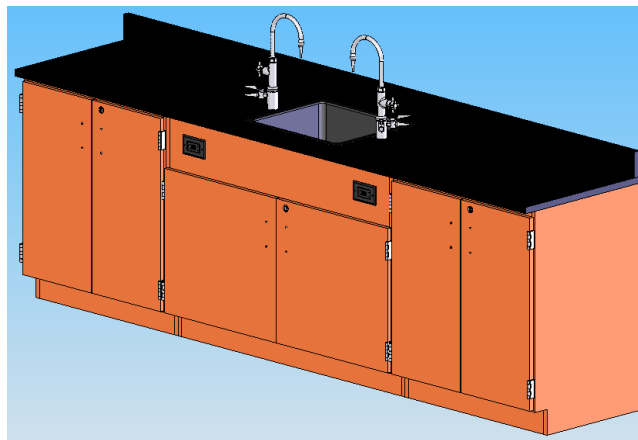

- Cut the rubber base molding for each side of the cabinet. Apply to the cabinet with the contact cement. Apply the 2 stainless steel corners to each of the cabinet corners with the #6 x 1/2" stainless steel screws.

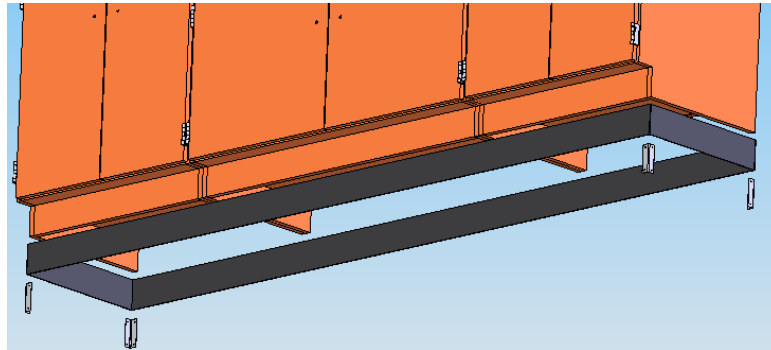

- Reverse pulls on the cabinet doors as shown.

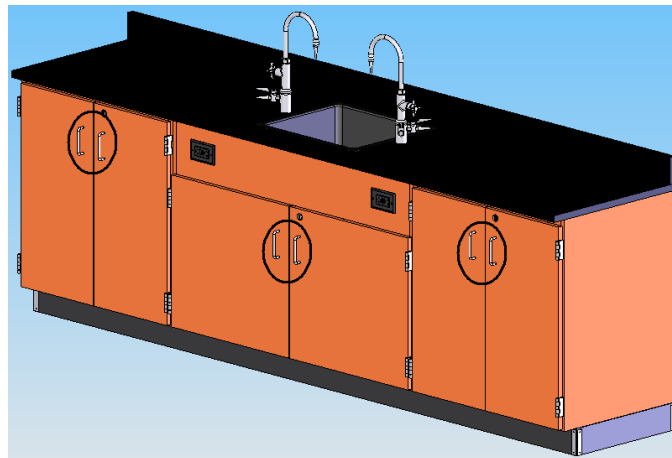

- All water, electrical and gas connections should be performed by a trained professional.**  
(Note: When multiple units are assembled together apply silicone to the edge of the tops that are being joined against each other. Remove any excess silicone. Allow 6-12 hours to cure.)

