

2816K PERIMETER WORKSTATION ASSEMBLY INSTRUCTIONS

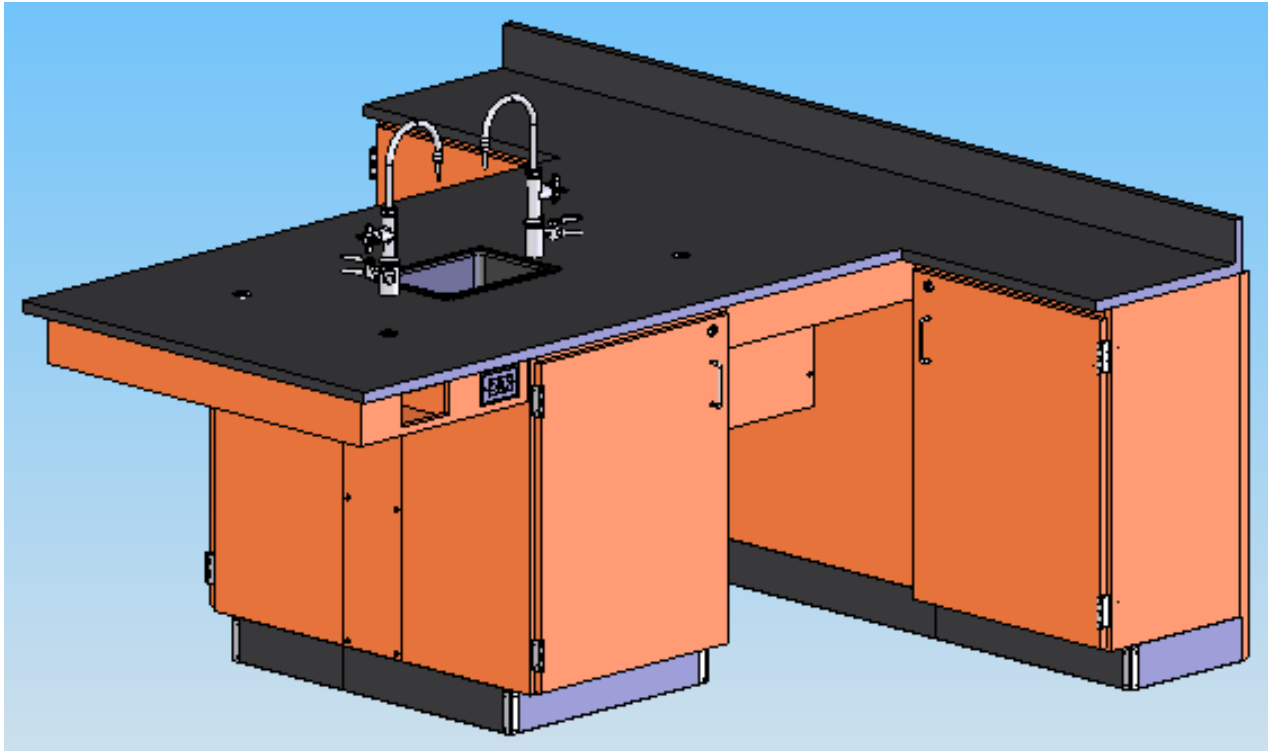

TABLE OF CONTENTS

	PAGE
REVISIONS TABLE.....	3
ASSEMBLY COMPONENTS.....	3
BASE ASSEMBLY.....	4
PERIMETER ASSEMBLY.....	4
ISLAND ASSEMBLY.....	5
WING ASSEMBLY.....	5
APRON RAIL ASSEMBLY.....	5
ROD SOCKET ASSEMBLY.....	6
TOP ASSEMBLY.....	7
BACKSPLASH ASSEMBLY.....	7
SINK ASSEMBLY.....	7
FIXTURE ASSEMBLY.....	8
UTILITY ASSEMBLY.....	8
CHASE ASSEMBLY.....	8
MOULDING ASSEMBLY.....	9
PULL ASSEMBLY.....	9

ASSEMBLY COMPONENTS

Items Included In Hardware Box	Part #		Part #
ASSEMBLY INSTRUCTIONS		1-HARDWARE BOX	
16 SHELF CLIPS	100027	2 FIXTURES,L65-WSA-DIV	100074
20 FT RUBBER BASE	100283	1 EPOXY SINK,L3	100691
6 RAIL CLEATS	100355	1 EPOXY TOP 42x66	100723-A
2 ELECTRICAL BOX	100033	1 EPOXY TOP 18X90	100723-B
2 ELEC,OUTLET,GFI,20A 125V,BLK	100034	1 EPOXY TOP 4X90	100723-C
4 ROD SOCKET ASSY	206505	4 ADJ SHELVES 14X22.19	200397-2218
6 SS CORNERS	100057	2 FILLER PANELS 12X24.25	BF122425KRC
24 SS #6x1/2 PTH SCREW	100064	1 FILLER PANEL 30X42	BF3042KRC
1 OUTLET/STAINER EPOXY	100055	2 FILLER PANEL 35X1	BF351KRC
1 PLASTIC TRAP	100056	2 FILLER PANEL 35X7	BF357KRC
1 SINK STOPPER	100112	1 FILLER PANEL 5X42	BF542KRC
1 SILICONE	100711	2 APRON RAILS 4.5X24.5	212009
8 SCREW,#6X1/2 PPH SMS	100475	1-APRON,ROD COMP, 20X38.625	207851
30 SCREWS, #10X1-1/2 PHIL TR, SMS	100495	24-SCREWS 8X3/4, TRUSS HEAD	100649

REV	DESCRIPTION	DATE	INITIAL
---	Original Created	3-13-07	JWD

Assembly Instructions for 2816K PERIMETER WORKSTATION

Items not included but needed for assembly:

1. Screwdrivers and wrenches
2. Contact cement
3. Utility Knife
4. Tape measure
5. Clear silicone adhesive
6. Drill and 1/8" drill bit

Instructions:

1. Find the two cabinets with cleats that run from top to bottom and place the two cabinets against the wall with the cleats facing each other. Cabinets should be placed 42" apart.

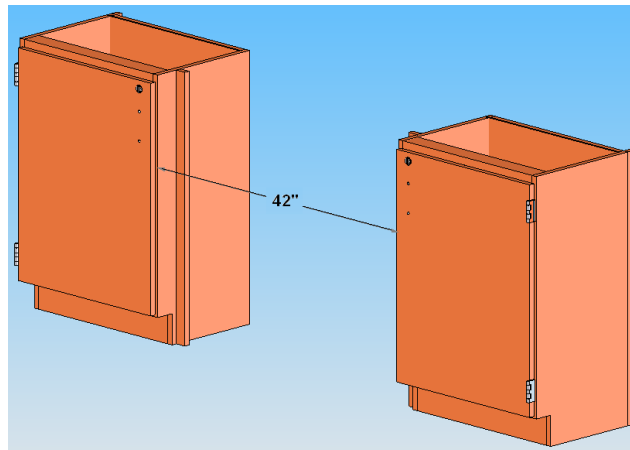

2. Screw the 42"x 30" access panel in place using the #10 x 1-1/2" Phillips truss head screws. (*NOTE: All cleats should be predrilled with 1/8" bit when attaching access panels and fillers.)

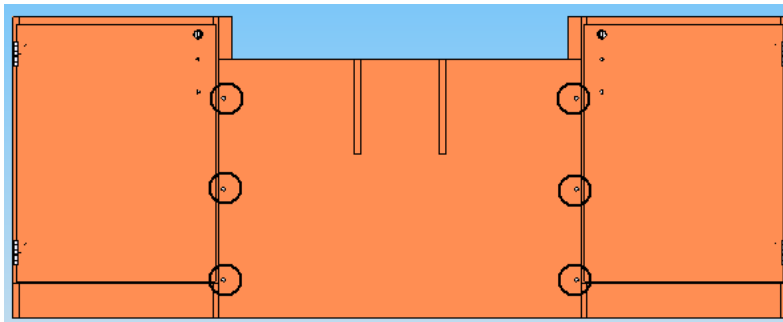

3. Screw the 5"x 42" base panel to the cleats on the two cabinets using the #10 x 1-1/2" Phillips truss head screws.

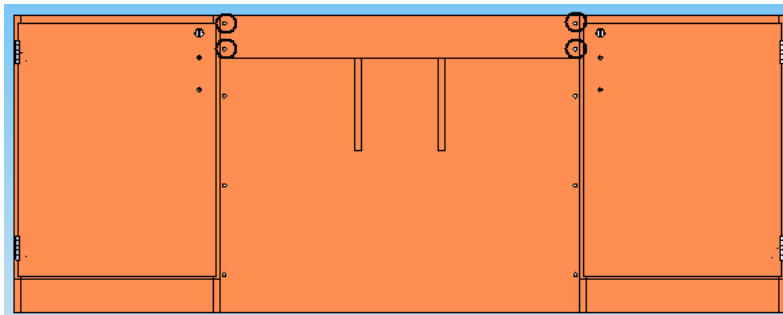

- Place remaining two units with 11" cleats (pointing towards the wall) back-to-back and secure 7" x 35" filler panels between the cabinets on each side using the #10 x 1-1/2" truss head screws.

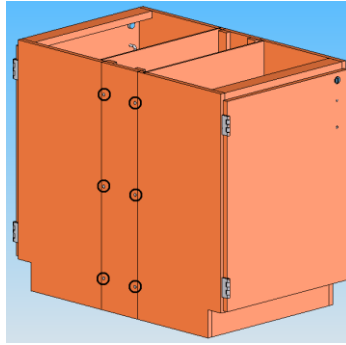

- Apply the steel rail cleats to the wing assembly (Figure 5A) and the (2) 24.25" x 4.5" rails (Figure 5B) with the #8 x 3/4" truss head screws.

Figure 5A

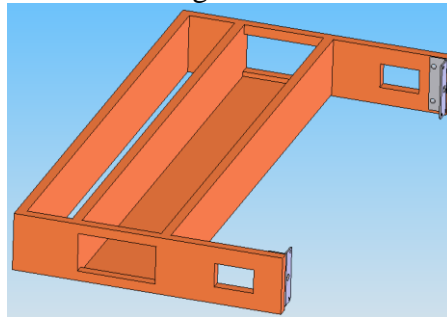
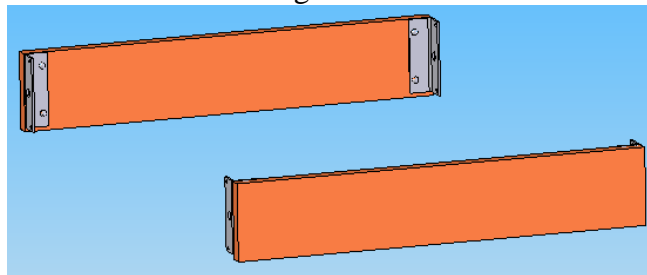
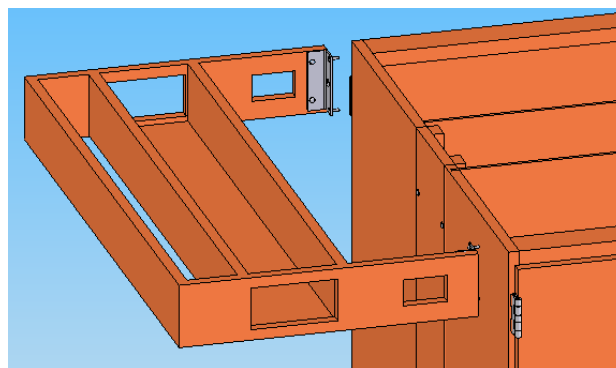

Figure 5B



- With one person holding the wing with rod storage, another person should attach it to the outside of the cabinets using #8 x 3/4" truss head screws. Support this wing until the top is secured. **They are not strong enough to withstand weight until top is attached.**



7. Attach the (2) 24.25" x 4.5" rails that goes between the back-to-back cabinets and the wall cabinets using the #8 x 3/4" truss head screws. Again it is recommended that two people perform this task.

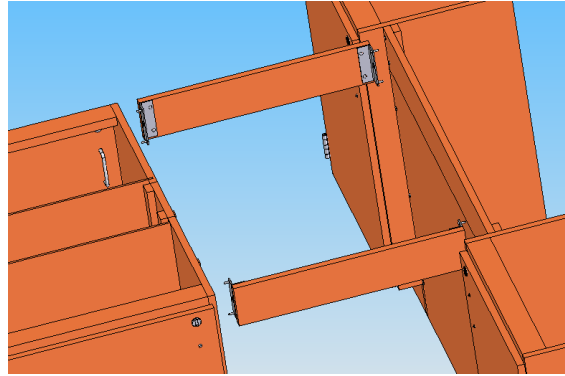

8. (If Applicable) Assemble the Rod Socket Assembly as shown in Figure 8A.
(If Applicable) Attach Rod Sockets to Top as shown in Figure 8B.

Figure 8A

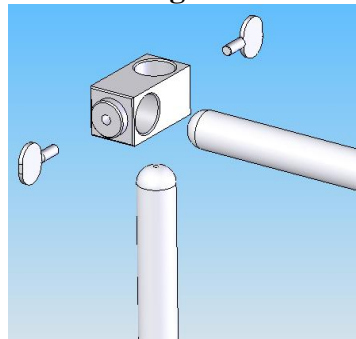
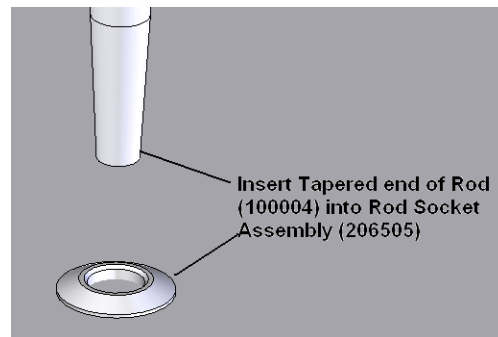
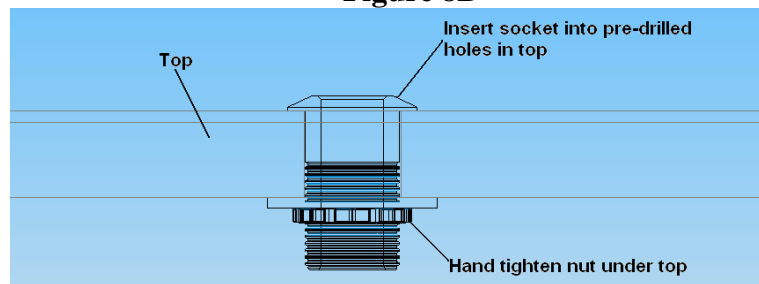
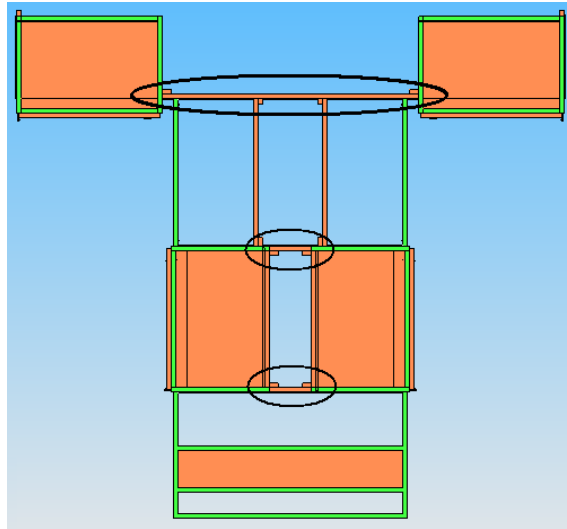

Figure 8B



9. Outline the top of the base unit with the silicone seal and place top on the unit. Make sure silicone is applied in between tops were one top butts against another. Be sure to center the top on the base unit before the silicone dries. **Do not apply adhesive to filler panels shown below, doing so will prohibit access to utilities connections.**



10. Clean the top with water only. Be sure the top is clean and dry before installing the backsplash. Using silicone adhesive, glue the epoxy back splash to the back of the top.

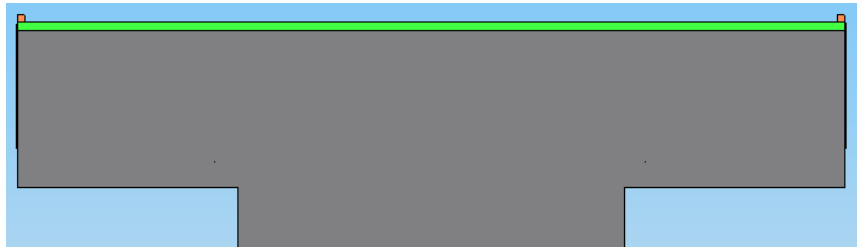

11. Put a bead of silicone seal along the cutout for the sink on the top. Lower sink in place.

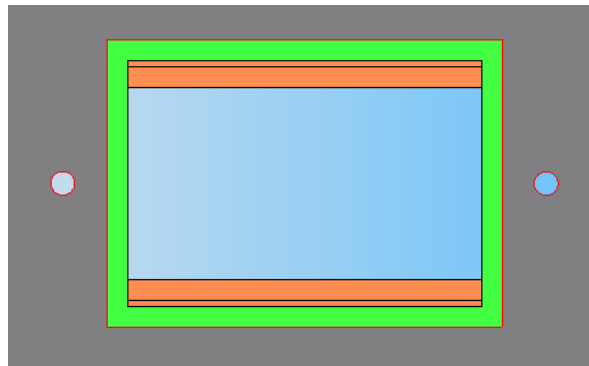

12. Mount fixtures into place.

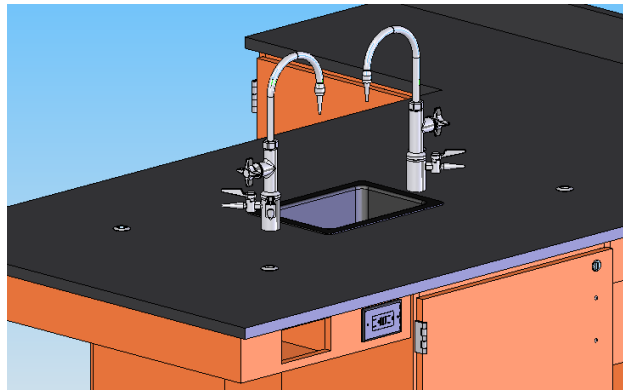

13. Remove the access panels to access the plumbing and gas. All water, electrical and gas connections should be performed by a trained professional.

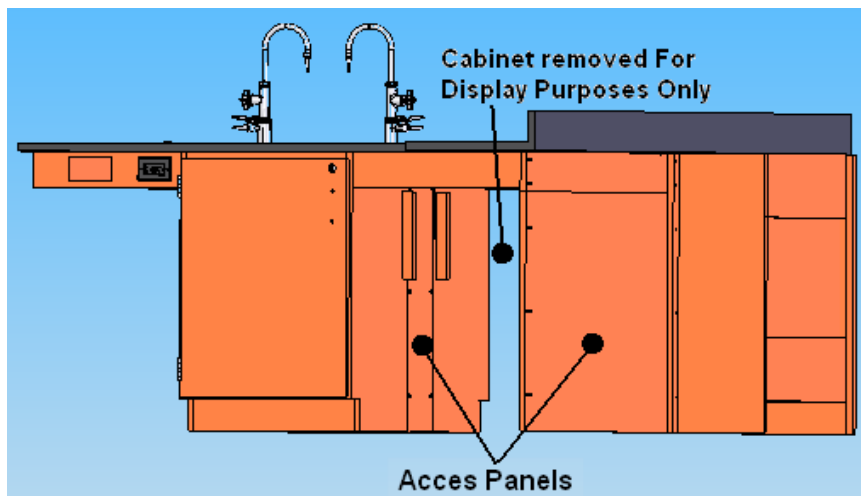

14. Attach the 24.25" x 12" plumbing chases to cleats using #10 x 1-1/2" truss head screws.

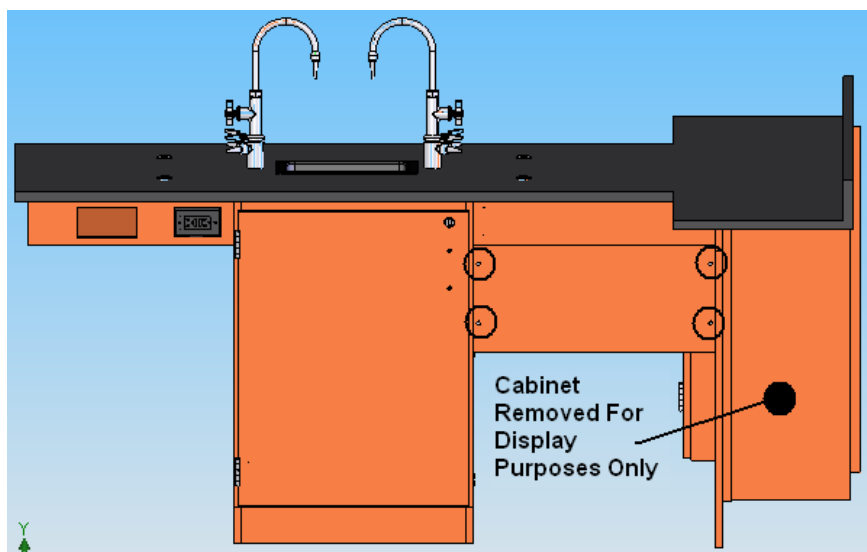

15. Attach the rubber base molding using contact cement. After molding is in place, screw stainless steel corner brackets on each corner over the base molding.

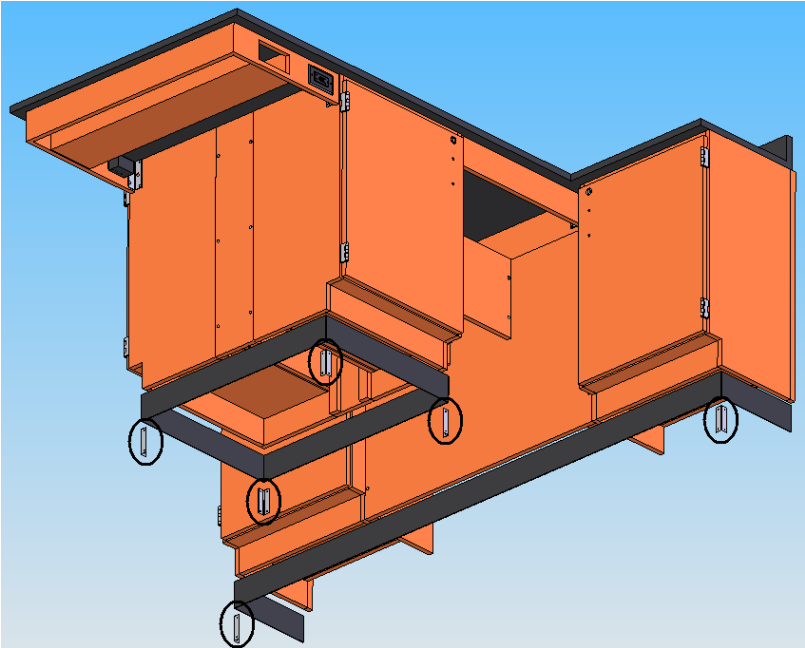

16. Reverse the door pulls as shown below.

