

## How-to Guide for Using 3D Preview Links

### Sharing the Lessons with Students

- Paste the science lesson links into online assignments, a classroom web page, or emails to your students.
- Each lesson has a unique description and link. Once the student clicks the link to access the science lesson, they can immediately start working through the interactive lesson. **Using the science lesson links will not require a login by the student.**

### Navigating through Science Lesson

- When clicking on the lesson links, you will notice login prompts at the top right but remember **login is not required** to access and use the lessons. So please ignore the login prompts.
- Each lesson begins with a page, that includes lesson objectives, lesson prerequisite skills, and the lesson table of contents. See the sample image below.
- Students can navigate through the lesson using any of the following:
  - the arrows at the top right of the lesson
  - clicking on the pages of the lesson table of content
  - using the navigation bar at the bottom of the lesson

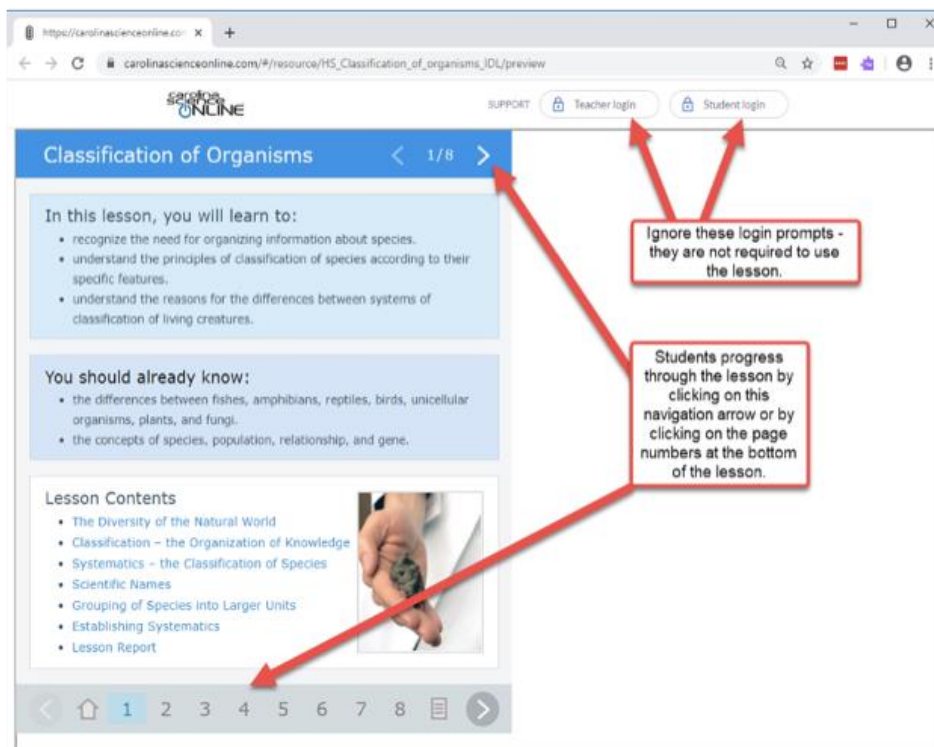

## Capturing Student Performance

- Each of these interactive engaging lessons includes animations, videos, and interactive exercises with assessments.
- The assessments are automatically graded so that students can see their performance as they go through the lesson and they can check their work.
- At the end of the lesson there is a lesson report page, that captures the student's overall performance for that specific lesson. It includes the number of times a student checked their answers and the number of incorrect responses. Please see the sample image below.
- Remember students are not required to login using these lesson links therefore the student performance is **not saved**.
- So, we highly recommend that if you want to track student progress, that you direct students to send you a **'screenshot' of the lesson report page** once they have completed their lesson.
-

Lessons are accessible from multiple browsers and screen resolutions. Some of the lessons are complex including animations, video, and audio resources, thus it may take a few moments for the lessons to load.

These lessons will continue to be available for free use by teachers and students until the current COVID-19 event has subsided.

If you need

assistance, please email [csso\\_support@carolina.com](mailto:csso_support@carolina.com) or use the Live Chat button located in the CSO “Top Navigation”

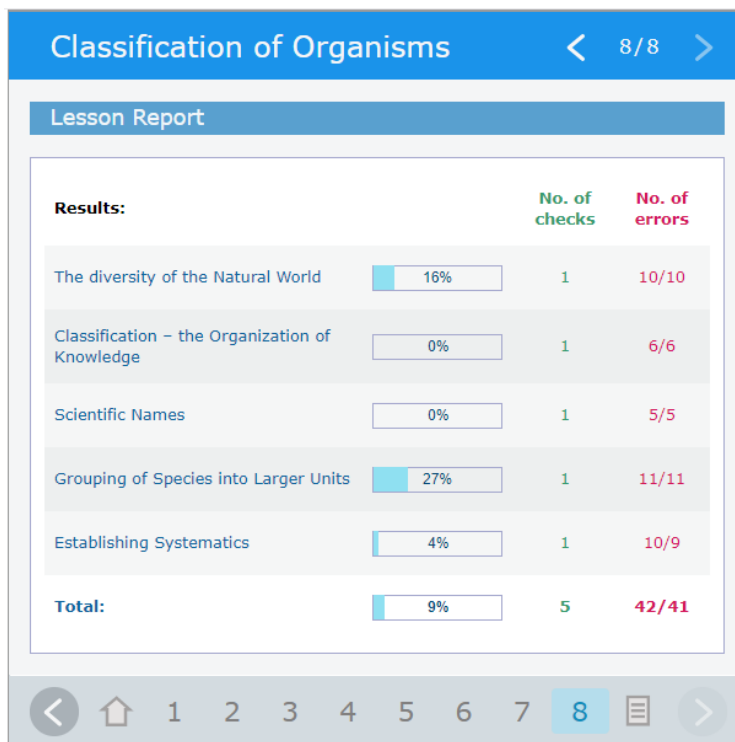

### Technology Requirements

accessible from multiple mobile devices with various resolutions. Some of the complex including animations, resources, thus it may take a the lessons to load.

### License Term

continue to be available for teachers and students until the event has subsided.

### Is help available?

assistance, please email [csso\\_support@carolina.com](mailto:csso_support@carolina.com) or button located in the CSO “Top header bar.